



# Vestil Manufacturing Co.

2999 North Wayne Street, P.O. Box 507, Angola, IN 46703

Telephone: (260) 665-7586 -or- Toll Free (800) 348-0868

Fax: (260) 665-1339

<http://www.vestil.com/> e-mail: [info@vestil.com](mailto:info@vestil.com)

## PS-4045 Adjustable-Height Pallet Stand



### Receiving Instructions

After delivery, remove the packaging from the product. Inspect the product closely to determine whether it sustained damage during transport. If damage is discovered, record a complete description of it on your bill of lading. If the product is undamaged, discard the packaging.

**NOTE:** The end-user is solely responsible for confirming that product design, use, and maintenance comply with laws, regulations, codes, and mandatory standards applied where the product is used.

### Technical Service & Replacement Parts

For answers to questions not addressed in these instructions and to order replacement parts, labels, and accessories, call our Technical Service and Parts Department at (260) 665-7586. The department can also be contacted online at <https://www.vestil.com/page-parts-request.php>.

### Electronic Copies of Instruction Manuals

Additional copies of this instruction manual may be downloaded from <https://www.vestil.com/page-manuals.php>.

Table of Contents	Page
Specifications.....	2
Signal Words.....	2
Safety Instructions.....	3
FIG. 1: PS-4045 Exploded View and Bill of Materials.....	3
FIG. 2: PS-4045-CA Exploded View and Bill of Materials.....	4
Adjusting the Height of the Pallet Stand.....	4
Loading & Unloading the Pallet Stand.....	4
FIG. 3: (Optional) PS-RF-CK Caster Kit Exploded View and Bill of Materials.....	5
(Optional) Caster Kit Installation Instructions.....	5 - 6
Installing the Carousel (Models PS-4045CA & PS-4045CA-CK.....	6
Inspections & Maintenance.....	7
Labeling Diagram.....	8
Limited Warranty.....	9

# SPECIFICATIONS

Specifications documents for PS-series adjustable (height) pallet stands are provided on Vestil's website. To access the appropriate specifications document, navigate to the *Adjustable Pallet Stands* webpage at <https://www.vestil.com/product.php?FID=278>. Click the *Product Specifications Table* drop-down menu bar under *Model Specific Details* partway down the page. Scroll the page to the entry for the model you purchased and click the button in the column titled *PDF* that looks like a yellow pencil inside a blue box. A PDF file will open. This file is the specifications document. Print a copy of the document and keep it with your copy of this manual. The following is an exemplar specifications document for model PS-4045.

## ADJUSTABLE PALLET STAND - PS-4045

APPROX WEIGHT: 253 lbs.  
DOES NOT INCLUDE WEIGHT OF POWER OR PACKAGING!!!

\*\*\* ANY ADDITIONS, DELETIONS, OR OMISSIONS MUST BE CORRECTED ON THIS DRAWING AS THIS DRAWING WILL BE CONSIDERED ALL INCLUSIVE \*\*\*  
ALL GRAPHICS PROVIDED ARE FOR REFERENCE ONLY. IF CERTAIN DIMENSIONS ARE CRITICAL PLEASE VERIFY THOSE DIMENSIONS WITH YOUR SALESPERSON

42 1/2"  
34 3/4"  
34 15/16" THIRD  
10" COLLAPSED

40 1/2"  
40"  
32"

3D VIEW SHOWN FOR  
REFERENCE ONLY

### STANDARD FEATURES

MODEL NUMBER IS PS-4045  
CAPACITY IS 5,000 POUNDS  
OVERALL WIDTH IS 40 1/2"  
PLATFORM WIDTH IS 40"  
OVERALL LENGTH IS 45 3/4"  
PLATFORM LENGTH IS 42 1/2"  
THIRD SETTING IS 34 15/16"  
SECOND SETTING IS 30 1/2"  
FIRST SETTING IS 20 1/4"  
COLLAPSED HEIGHT IS 10"  
TOUGH BAKED IN POWDER  
COATED BLUE FINISH

### SPECIAL FEATURES

NONE

DIMENSION TOLERANCE ± 1/4"

I, THE UNDERSIGNED, AGREE THAT THE PRODUCT AS REPRESENTED SATISFIES DESIGN AND DIMENSION REQUIREMENTS. I ALSO ACKNOWLEDGE MY DUTY TO CONFIRM PRODUCT AND INSTALLATION COMPLIANCE WITH ALL APPLICABLE FEDERAL, STATE AND LOCAL REGULATIONS AND STANDARDS.

UNITS REQUIRING APPROVAL DRAWINGS OR MODIFIED ARE NON-RETURNABLE

[ ] As drawn [ ] As marked

Signed: \_\_\_\_\_ Date: \_\_\_\_\_

Printed Name: \_\_\_\_\_

LEAD TIME WILL START UPON RECEIPT OF SIGNED APPROVAL DRAWING

DISTRIBUTOR'S NAME:		P.O.#
VESTIL MANUFACTURING		X
DRAWN BY: ND	DATE: XX/XX/XX	SALES: X
REFERENCE: X	SCALE: 1:12	FILE NAME:
QUOTED LEAD TIME: X	QUOTE # X	15-007-011

## SIGNAL WORDS

This manual uses SIGNAL WORDS to indicate the likelihood of personal injuries, as well as the probable seriousness of those injuries, if the product is misused in the ways described. Other signal words call attention to uses of the product likely cause property damage. The signal words used appear below along with the meaning of each word.

<b>⚠ DANGER</b>	<b>Identifies a hazardous situation which, if not avoided, <u>WILL</u> result in DEATH or SERIOUS INJURY. Use of this signal word is limited to the most extreme situations.</b>
<b>⚠ WARNING</b>	<b>Identifies a hazardous situation which, if not avoided, <u>COULD</u> result in DEATH or SERIOUS INJURY.</b>
<b>⚠ CAUTION</b>	<b>Indicates a hazardous situation which, if not avoided, <u>COULD</u> result in MINOR or MODERATE injury.</b>
<b>NOTICE</b>	<b>Identifies practices likely to result in product/property damage, such as operation that might damage the crane.</b>

# SAFETY INSTRUCTIONS

Vestil strives to identify foreseeable hazards associated with the use of its products. However, no manual can address every conceivable risk. The most effective way to avoid injury is to exercise sound judgment while assembling, using, inspecting, or maintaining your pallet stand. **Keep a copy of this manual with the device at all times.** For example, put the copy inside a plastic pouch and attach the pouch to the frame.

## ⚠ WARNING

Material handling is dangerous and could result in serious personal injuries. **Read and understand the entire manual before assembling, using or servicing the pallet stand.** Read the manual whenever necessary to refresh your understanding of recommended use, inspection and maintenance procedures.

- DO NOT install the stand outdoors or in corrosive environments. ONLY install this product on compacted, improved surfaces (e.g. concrete) that are level and even. The surface must be capable of easily supporting the combined weight of the stand and a full capacity load. Attach the pallet stand to a concrete surface with 1/2" anchor bolts that are at least 4" long before using the stand for the first time.
- DO NOT use the stand unless it is in SATISFACTORY CONDITION. Inspect the unit as described in the INSPECTION instructions on p. 7. DO NOT use the stand unless it passes every part of the inspection or until it is restored to satisfactory condition.
- DO NOT use the pallet stand to lift people.
- DO NOT stand on or climb onto the stand.
- Always watch the stand carefully while applying a load to it.
- Avoid pinch points. Pinch points are created as the table rises and lowers do to the pivoting motion of the scissor legs. NEVER reach into or put any part of your body between the scissor legs.
- Always apply the LOADING & UNLOADING THE PALLET STAND instructions on p. 4. Center and evenly distribute all loads applied to it. The top of the stand should not move as weight is applied to it. Watch for movement and listen for unusual noises. Remove the unit from service if you observe anything abnormal.
- DO NOT apply loads to this table on broken or damaged pallets. Examine each pallet before applying it to the stand to confirm that no nails protrude from the surfaces and that all boards are intact. A damaged/broken pallet might break while on the stand. A damaged pallet could interfere with carousel rotation (stand model PS-4045CA). Sudden stops while rotating the tabletop can cause loads to shift or fall.
- To remove a load from the stand, lift it high enough that it clearly is no longer in contact with the top of the stand before backing away from the table.
- (Pallet stands equipped with caster kit option PS-RF-CK) If the stand must be moved, completely unload it first. Always lock both caster locks (see FIG. 3 on p. 5) whenever the stand is loaded or in storage.
- DO NOT leave loads applied to the stand for long periods of time.
- DO NOT use this stand UNLESS all labels are in place & readable. See LABELING DIAGRAM on p. 8.
- DO NOT modify this product in any way without written approval from Vestil. Unapproved modifications automatically void the LIMITED WARRANTY (see p. 9) & might make it unsafe to use.

**FIG. 1: PS-4045 EXPLODED VIEW AND BILL OF MATERIALS**

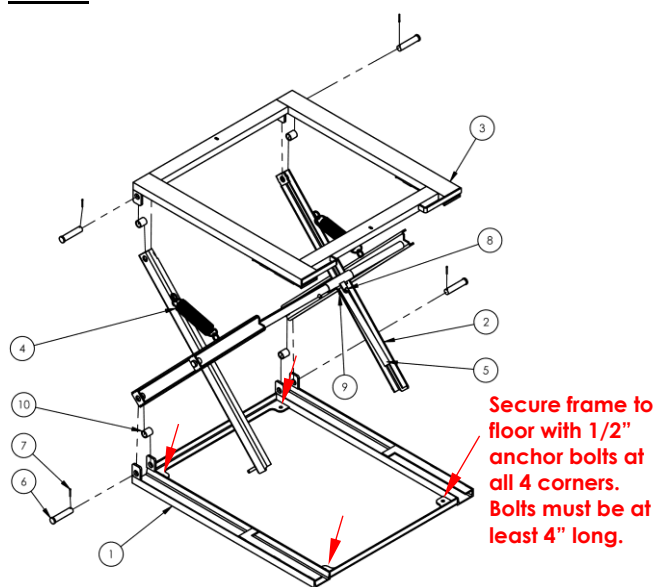

Item	Part no.	Description	Qty.
1	15-514-012	WELDMENT, FRAME, BASE	1
2	15-510-009	SUBASSEMBLY, LEGS	1
3	15-514-011	FRAME, TOP ASSEMBLY	1
4	15-146-001	SPRING, EXTENSION, W/FULL LOOP, 13.57#/IN	2
5	15-025-002	HANDLE, ADJUSTING	1
6	33-112-023	PIN, CLEVIS	4
7	65078	EXTENDED PRONG COTTER PIN, ZINC FINISH, 1/8" x 1 1/2"	4
8	11112	3/8-16 x 2 1/4 LONG HHCS, GRADE A	1
9	37024	NYLON INSERT LOCK NUT, GRADE 2, ZINC FINISH, 3/8"-16	1
10	15-113-002	SPACER	4

**FIG. 2: PS-4045-CA EXPLODED VIEW AND BILL OF MATERIALS**

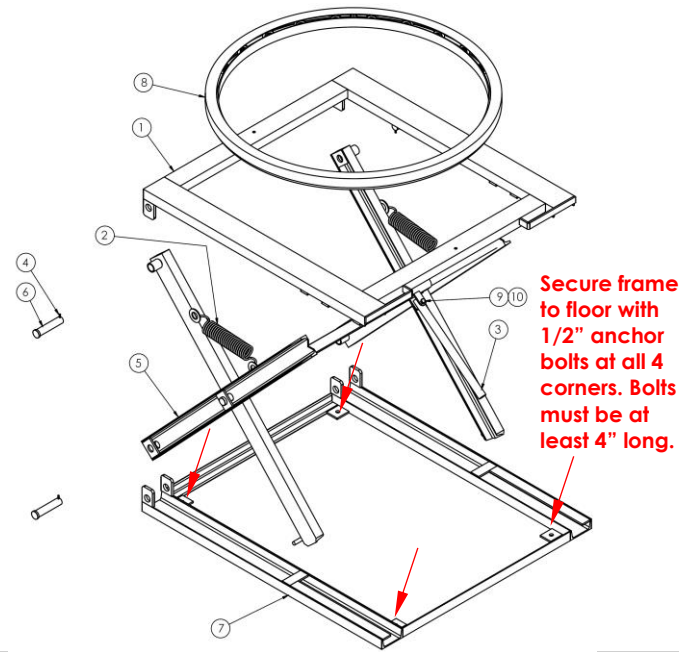

Item	Part no.	Description	Qty
1	15-514-011	Frame, tabletop assembly	1
2	15-146-001	Spring	2
3	15-025-002	Handle, height adjustment	1
4	65078	Extended prong cotter pin, zinc finish, 1/8" x 1 1/2"	4
5	15-510-009	Scissor legs, subassembly	1
6	33-112-023	Pin, axle	4
7	15-514-012	Frame, base assembly	1
8	20-001-015 20-514-015 20-013-022 20-110-006 68083	Carousel, assembly: a. Weldment, inner ring b. Deck, outer retaining ring c. Roller bearing d. E-clip, steel, for 5/8" shaft	1 1 1 1 1
9	11112	3/8" - 16 x 2 1/4" HHCS bolt	1
10	37024	3/8" - 16 grade 2 zinc finish lock nut	1
11	15-113-002	Spacer	4

**ADJUSTING THE HEIGHT OF THE PALLET STAND**

**▲ WARNING**

DO NOT adjust the height of the tabletop while the stand is loaded. Completely unload the stand before adjusting the height.

PS-4045 series pallet stands can be adjusted between **4 configurations**: 1) fully lowered (for storage only); 2) Low height setting; 3) Intermediate height setting; and 4) Maximum height setting.

Adjust the height of the tabletop by grabbing the red handle grip and pivoting the handle until it is perpendicular to the handle frame bar. While holding the handle, lift the tabletop. Use the handle to adjust the position of the scissor legs as necessary; then lower the tabletop. There are triangular notches in the tops of the free legs. The selected adjustment cross bars must seat into the notches in the free legs. When the adjustment is finished, fold the handle against the handle frame bar.

Put the stand into the **fully lowered/storage configuration** by holding the handle and lifting the tabletop. Use the handle to lower the legs to the base frame.

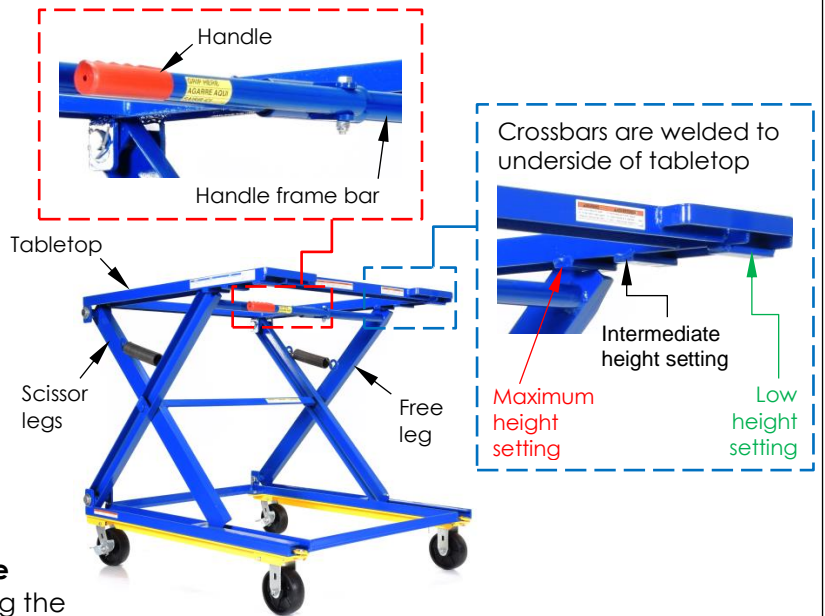

**LOADING & UNLOADING THE PALLET STAND**

Before applying a palletized load to the stand, make sure that the load is centered on the pallet. Gently apply the pallet to the top of the stand. Center the pallet on the top of the stand. Neither the pallet nor the load should overhang the top of the stand.

Be cautious whenever removing a loaded pallet from the stand. Insert the forks of your lift truck through the pallet and slowly raise them. Continue to raise the forks until the top of the stand is several inches below the bottom of the pallet before backing away from the table.

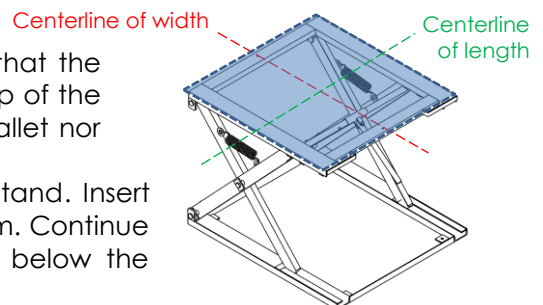

**FIG. 3: (OPTIONAL) PS-RF-CK CASTER KIT EXPLODED VIEW AND BILL OF MATERIALS**

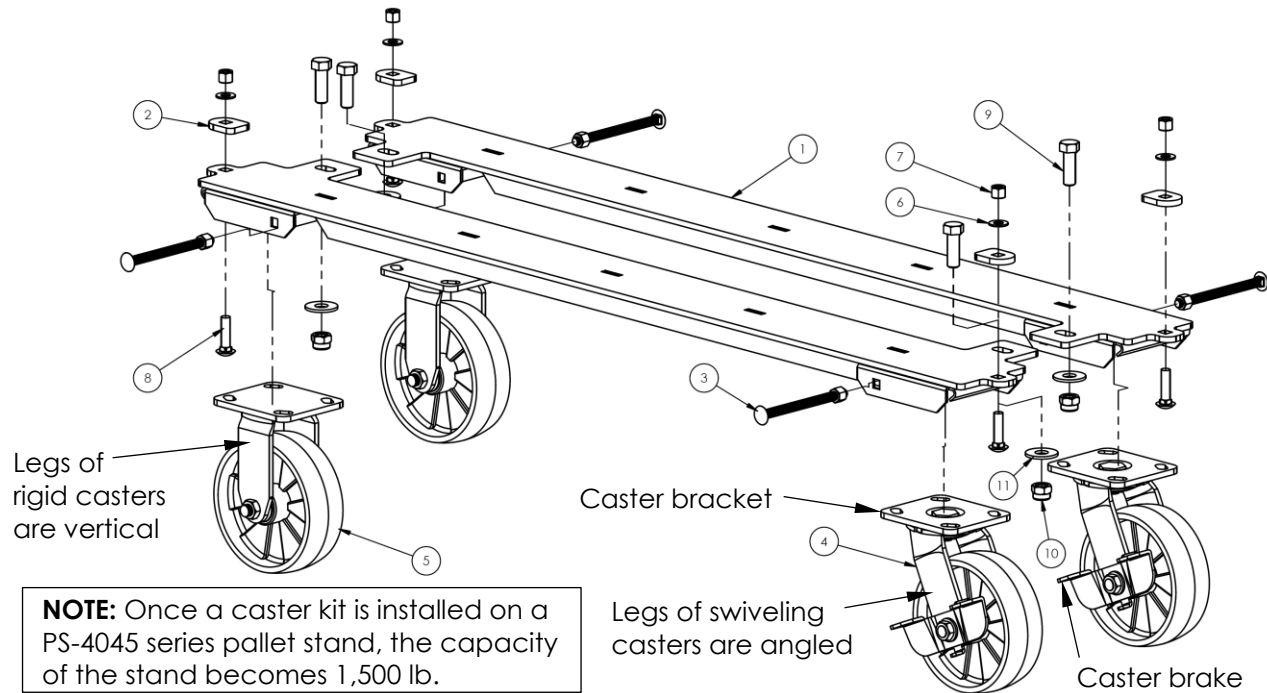

Item	Part no.	Description	Qty.	Item	Part no.	Description	Qty.
1	15-516-025	Weldment, bracket, caster	2	7	37024	3/8" - 16 grade 2 zinc finish lock nut	4
2	15-016-158	Bracket, caster clamp	4	8	21819	3/8" - 16 x 1 1/2" zinc-plated carriage bolt	4
3	99-612-001	Bolt and nut combo. 3/8" - 16 x 5" carriage bolt 3/8" - 16 nut	4	9	11209	1/2" - 16 x 1 1/2" HHCS #2 zinc-plated hex head bolt	4
4	16-132-261	6" x 2" glass filled nylon swivel caster with brake	2	10	37030	1/2" - 13 lock nut	4
5	16-132-263	6" x 2" glass filled nylon rigid caster	2	11	33012	1/2" zinc finish, low carbon flat washer	4
6	33008	3/8" USS zinc-finish flat washer	4				

**(OPTIONAL) CASTER KIT INSTALLATION INSTRUCTIONS**

Refer to [FIG. 3](#) for parts identifications. Numbers in parentheses correspond to item numbers in the bill of materials.

1. To install the optional caster kit, first lower the tabletop completely to put the pallet stand into the collapsed/storage configuration. Then, overturn the stand so that the bottom of the frame is facing upwards.

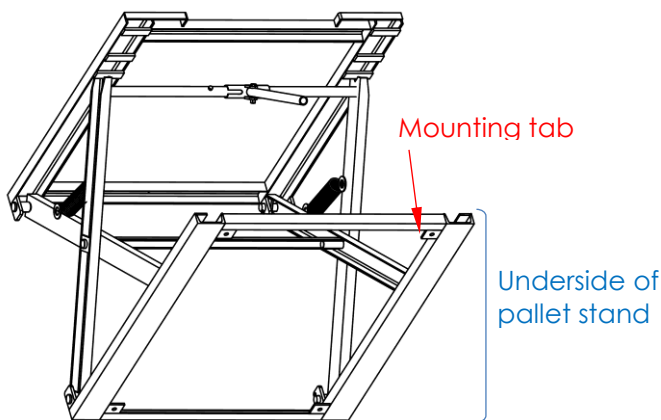

2. When you receive the caster kit, the **caster clamping brackets** (2) will still be attached to the **caster bracket weldment** (1). Use a pair of pliers to bend the **mounting brackets** back and forth until they snap off of the weldments.

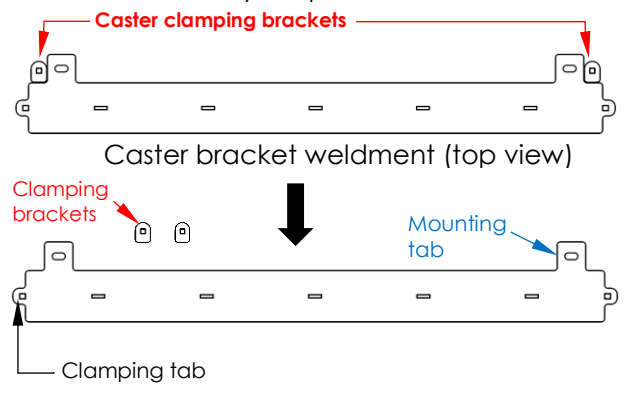

3. Fasten the weldments (2) to the bottom of the pallet stand.
  - a. Align the mounting tabs on the underside of the stand with the mounting tabs on the caster bracket weldments.
  - b. Then, insert hex head bolts (9) through the tabs and secure the bolts with flat washers and lock nuts (10 & 11).
4. Attach the clamping brackets.
  - a. Insert 1 1/2" carriage bolts up through each clamping tabs (see Step 2 on [p. 5](#)) of both caster weldments (1).
  - b. Put a clamping bracket onto the end of each bolt. The flat end of the brackets should overlap the base frame.
  - c. Secure the bolts with flat washers (6) and lock nuts (7).
5. Attach the casters.
  - a. Install the caster bracket of a caster into each of the 4 caster receivers as diagrammed above (swivel casters in back; rigid casters in front).
  - b. Insert a 5" carriage bolt (3) bolt through the bolts holes in each of the caster receivers. Tighten the corresponding lock nut on the end of the bolt to secure the caster inside its receiver.

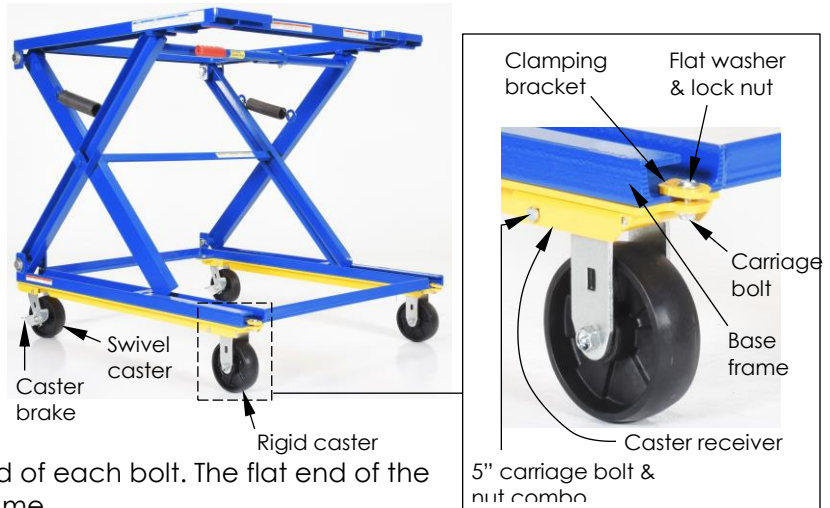

### INSTALLING THE CAROUSEL (MODELS PS-4045CA & PS-4045CA-CK)

**NOTE:** The carousel weighs approximately 45 pounds (20.5kg). It is difficult for 1 person alone to handle the carousel. At least 2 persons should participate in this installation.

There are 2 slots on opposite sides of the bottom/inner ring of the carousel (20-514-015). Align the slots in the carousel with the bolt holes in the top frame assembly (15-514-011). Put a **flat washer (33008)** on 2 **bolts (11105)**. Insert the bolts up through the bolts holes on the frame and through the slots in the bottom of the carousel. Put a **lock washer (33622)** on the end of each bolt. Secure the bolts with **hex nuts (36106)**. Tighten the nuts onto the bolts using 9/16" socket wrenches.

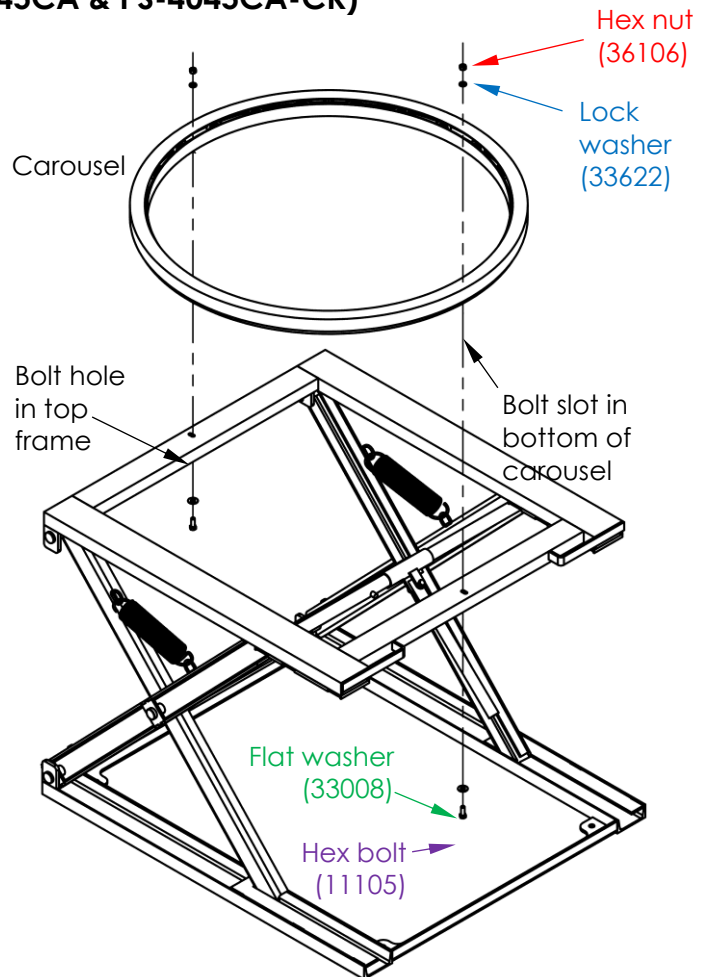

## RECORD OF SATISFACTORY CONDITION (THE “RECORD”)

After anchoring the pallet stand to the floor with appropriate hardware (1/2" x 4" long anchor bolts) and before using it for the first time, make a record describing its appearance and operation. Thoroughly photograph the pallet stand from multiple angles. Include photos of all welds, anchor points, the height adjustment cross bars (see [ADJUSTING THE HEIGHT OF THE PALLET STAND](#) on p. 4), the handle and handle frame bar, and each label. Adjust the height of the tabletop to each of the 4 height settings. Describe how much effort is required to adjust the height. If your pallet stand includes a manual carousel, turn the carousel clockwise and counterclockwise. Describe the sound of the carousel. How much force is required to turn it? Does the carousel wobble? Collect all photographs and writings in a file. Mark the file appropriately to identify it. This file is a record of the pallet stand in satisfactory condition. Compare the results of all inspections to this *RECORD* to determine if the lift table is in satisfactory condition. Do not use the lift table unless it is in satisfactory condition.

## INSPECTIONS & MAINTENANCE

### NOTICE

Proper use and maintenance are essential for this product to function properly.

- Always use this product in accordance with the instructions in this manual.
- Periodically lubricate moving parts and pivot points.
- Keep the product clean & dry at all times.
- Only use approved replacement parts. To order replacement/spare parts for this device, contact the factory.

If any of the inspections described below reveal problems with the stand, remove it from service and tag it “Out of Service”. Restore the unit to [SATISFACTORY CONDITION](#) before using it again.

A. Before each use, inspect the following components. Each component must be in normal operating condition. To establish normal operating condition, make a thorough record of the appearance of the various parts of the stand when you first receive it. Compare later observations to this record to determine whether the machine is in normal operating condition.

1. Frame: examine the base, scissor legs, tabletop, and carousel (if equipped with this option). Look for damaged welds, warps, cracks, or other deformations.
2. Casters (only units equipped with caster kit option PS-RF-CK): examine each caster. Confirm that casters are not severely worn, that the wheels rotate freely, that both swivel casters swivel properly, and that the brakes firmly engage the wheels.
3. Springs: The springs should stretch uniformly and equally, and should resist movement of the legs. Apply the load/pallet to the stand. Listen for unusual sounds and watch for unusual movement. If you notice anything atypical, unload the stand and determine the cause of the issue.
4. Fasteners: check nuts and bolts. Make sure all fasteners are tightly connected.
5. Roller bearings (only units equipped with carousel option): rotate the carousel. Watch and listen to the carousel as it rotates. If unusual noise is produced, or if the carousel binds, wobbles, or lurches, remove it and examine the roller bearings. Rotate each bearing to determine if it requires lubrication. Replace all bearings that are significantly worn. Clean the underside of the carriage where the bearings make contact with it to remove debris that might interfere with bearing movement.
6. Surface coating: Inspect the paint/powdercoat. Clean all areas where the surface coating is damaged (chipped, missing, etc.) with soap and water. Dry the affected areas and apply touchup paint.
7. Labels: Make sure that every label is in place, undamaged, and easily readable.

B. At least once per month:

1. Clean the entire stand: Remove dirt and other matter from all surfaces with a mild soap and water solution.
2. Lubricate pivot points as necessary.

## LABELING DIAGRAM

The unit should be labeled as shown in the diagram. However, content and location of each label are subject to change. Replace all labels that are damaged, missing, or not easily readable (e.g. faded). Order replacement labels by contacting the [TECHNICAL SERVICE AND PARTS DEPARTMENT](mailto:technical@vestil.com) online at <https://www.vestil.com/page-parts-request.php>. Alternatively, you may request replacement parts and/or service by calling (260) 665-7586 and asking the operator to connect you to the Technical Service & Parts Department.

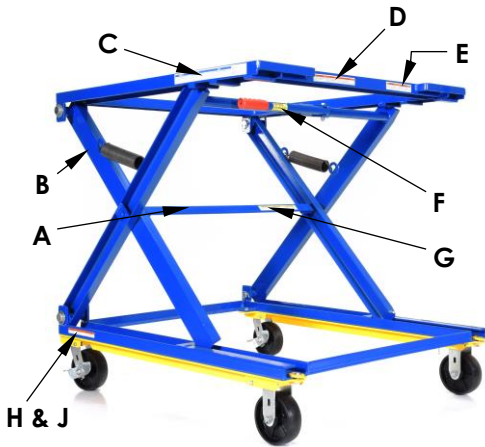

### A: Label 1153

MODEL / MODÉLO / MODÈLE _____
WEIGHT / PESO / MASS _____
CAPACITY / CAPACIDAD / CAPACITÉ _____
SERIAL / SERIE / SÉRIE _____
UNITS: 2.2 lb. = 1kg      1" (or 1in.) = 2.54cm      1153

### B: Label 208

⚠ WARNING	⚠ ADVERTENCIA	⚠ AVERTISSEMENT
KEEP CLEAR OF PINCH POINT	MANTENGASE ALEJADO DEL PUNTO DE CORTE	SE TENIR À DISTANCE DU POINT DE PINCEMENT

### C: Label 261

NOTICE	NOTA	AVIS	261 rev 0105
<b>OPERATING INSTRUCTIONS</b> To adjust height engage handle bar and lift on either lifting handle to engage positive locking device.	<b>INSTRUCCIONES DE OPERACIÓN</b> Para ajustar la altura encaje la barra de manejo y eleve la barra de elevación para que el sistema de cierre se encaje.	<b>INSTRUCTIONS DE FONCTIONNEMENT</b> Pour ajuster la hauteur, engager la barre de manoeuvre et soulever une ou l'autre des poignées d'élevation afin d'engager le blocage de sécurité.	

### D: Label 658

⚠ WARNING	⚠ ADVERTENCIA	⚠ AVERTISSEMENT	658 rev 0808
Do not operate or move with unstable loads DO NOT LOAD beyond rated capacity DISTRIBUTE LOAD EVENLY DO NOT sit or ride	No use a mueva con cargas inestables No cargue mas de la capacidad tasada DISTRIBUYA LA CARGA A NIVEL NO SE SIENTE o vaya en el carro	Ne pas utiliser avec une charge instable NE PAS CHARGER au-delà du débit nominale DISTRIBUER la charge régulièrement NE PAS VOUS ASSEoir OU VOUS PROMENER sur le chariot	

### E: Label 213

⚠ WARNING	⚠ ADVERTENCIA
Stand must be level and stable Do not load beyond rated capacity Center and Distribute load evenly	El soporte debe ser el nivel y estable No cargue más allá de la capacidad calculada El centro y Distribuye laod regularmente

### F: Label 262

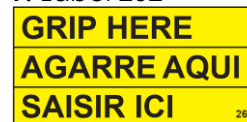

### G: Label 641

⚠ CAUTION	⚠ ATENCIÓN	⚠ ATTENTION	641 rev 0211
Capacity reduced to 1,500 lbs. when equipped with caster option. DO NOT move when loaded.	Capacidad reducida a 1,500 lbs. cuando equipado con la opcion de rueda. No mueva cuando este cargado.	Capacité réduite à 680 kg américaines quand équipée avec option de roulettes. NE PAS DÉPLACER chargée.	

### H: Label 204 (not relevant if unit equipped with caster kit)

⚠ WARNING	⚠ ADVERTENCIA	⚠ AVERTISSEMENT	204 Rev 11/10
SECURE FRAME TO FLOOR	ASEGURE EL BASTIDOR AL PISO	FIXER SOLIDEMENT LE CADRE AU PLANCHER	

### J: Label 212 (relevant if equipped with caster option)

⚠ WARNING	⚠ ADVERTENCIA	⚠ AVERTISSEMENT	212 Rev 09/20
Immobilize by applying all caster brakes and/or floor locks when in use, loading, and unloading.	Inmovilice aplicando todos los frenos de las ruedas y / o bloques del piso cuando esté en uso, cargando y descargando.	Immobiliser en appliquant tous les freins des roulettes et / ou les verrous de plancher lors de l'utilisation, du chargement et du déchargement.	



**LIMITED WARRANTY**

Vestil Manufacturing Company ("Vestil") warrants this product to be free of defects in material and workmanship during the warranty period. Our warranty obligation is to provide a replacement for a defective, original part covered by the warranty after we receive a proper request from the Warrantee (you) for warranty service.

**Who may request service?**

Only a warrantee may request service. You are a warrantee if you purchased the product from Vestil or from an authorized distributor AND Vestil has been fully paid.

**Definition of "original part"?**

An original part is a part used to make the product as shipped to the Warrantee.

**What is a "proper request"?**

A request for warranty service is proper if Vestil receives: 1) a photocopy of the Customer Invoice that displays the shipping date; AND 2) a written request for warranty service including your name and phone number. Send requests by one of the following methods:

<u>US Mail</u>	<u>Fax</u>	<u>Email</u>
Vestil Manufacturing Company	(260) 665-1339	<a href="mailto:info@vestil.com">info@vestil.com</a>
2999 North Wayne Street, PO Box 507	<u>Phone</u>	Enter "Warranty service request"
Angola, IN 46703	(260) 665-7586	in subject field.

In the written request, list the parts believed to be defective and include the address where replacements should be delivered. After Vestil receives your request for warranty service, an authorized representative will contact you to determine whether your claim is covered by the warranty. Before providing warranty service, Vestil will require you to send the entire product, or just the defective part (or parts), to its facility in Angola, IN.

**What is covered under the warranty?**

The warranty covers defects in the following original, dynamic parts: motors, hydraulic pumps, motor controllers, and cylinders. It also covers defects in original parts that wear under normal usage conditions ("wearing parts"), such as bearings, hoses, wheels, seals, brushes, and batteries.

**How long is the warranty period?**

The warranty period for original dynamic components is 1 year. For wearing parts, the warranty period is 90 days. Both warranty periods begin on the date Vestil ships the product to the Warrantee. If the product was purchased from an authorized distributor, the periods begin when the distributor ships the product. Vestil may, at its sole discretion, extend a warranty period for products shipped from authorized distributors by up to 30 days to account for shipping time.

**If a defective part is covered by the warranty, what will Vestil do to correct the problem?**

Vestil will provide an appropriate replacement for any covered part. An authorized representative of Vestil will contact you to discuss your claim.

**What is not covered by the warranty?**

The Warrantee (you) is responsible for paying labor costs and freight costs to return the product to Vestil for warranty service.

**Events that automatically void this Limited Warranty.**

- Misuse;
- Negligent assembly, installation, operation or repair;
- Installation/use in corrosive environments;
- Inadequate or improper maintenance;
- Damage sustained during shipping;
- Collisions or other accidents that damage the product;
- Unauthorized modifications: Do not modify the product IN ANY WAY without first receiving written authorization from Vestil.

**Do any other warranties apply to the product?**

Vestil Manufacturing Co. makes no other express warranties. All implied warranties are disclaimed to the extent allowed by law. Any implied warranty not disclaimed is limited in scope to the terms of this Limited Warranty. Vestil makes no warranty or representation that this product complies with any state or local design, performance, or safety code or standard. Noncompliance with any code or standard is not a defect.

